

SERIES	PRODUCT FAMILY	VERSION	MODEL
900	PANS	ELECTRIC	NEPE9I15

DESCRIPTION

ELECTRIC PAN INDIRECT HEATING 150 LITRES



TECHNICAL DATA:

STRUCTURE	150 LT.	WELL CAPACITY	150 LT.
WIDTH	800 mm	WELL DIMENSIONS	Ø 595x530 mm
DEPHT	900 mm		
HEIGHT	900 mm		
NET WEIGHT	138 kg		
VOLUME	1.1 m3		
ELECTRIC POWER	21 kW		
PHASE	3N		
FREQUENCY	50/60 Hz		
VOLTAGE	400 V		

SERIES	PRODUCT FAMILY	VERSION	MODEL
900	PANS	ELECTRIC	NEPE9I15

FEATURES:

Electric Boiling Pan, Monoblock unit with indirect heating made of stainless steel AISI 304. Stainless steel top (AISI 304), thickness 20/10, pre-fitted for head-to-head connection. Pan bottom made of stainless steel AISI 316L, polished, sides made of stainless steel AISI 304. 150 lt. - well capacity. Hot or cold water is loaded through electric valve activated by a switch, fixed water tap positioned on the top. 2 safety drain tap with thermostable grip. Lid opening 90°, balanced by front and side handle. Indirect heating by low pressure steam generated thanks to the water contained in the interspace of the kettle: pressure gauge assisted conduction, safety valve and automatic drainage valve. Control system with signal light in case of low water levels in the interspace, heating is activated again as soon as water is refilled up to standard level. Indirect heating via shielded electrical resistances inside the interspace. Thick insulating panels provide thermal insulation for the kettle. Temperature controlled via power regulator. Signal light checks whether the appliance is operating correctly. Kettle diameter 60 cm. Model with safety thermostat and rest button accessible to the user. Height-adjustable feet in stainless steel.

OPTIONAL ACCESSORIES:

SERIES	PRODUCT FAMILY	VERSION	MODEL
900	PANS	ELECTRIC	NEPE9I15

INSTALLATION SCHEME

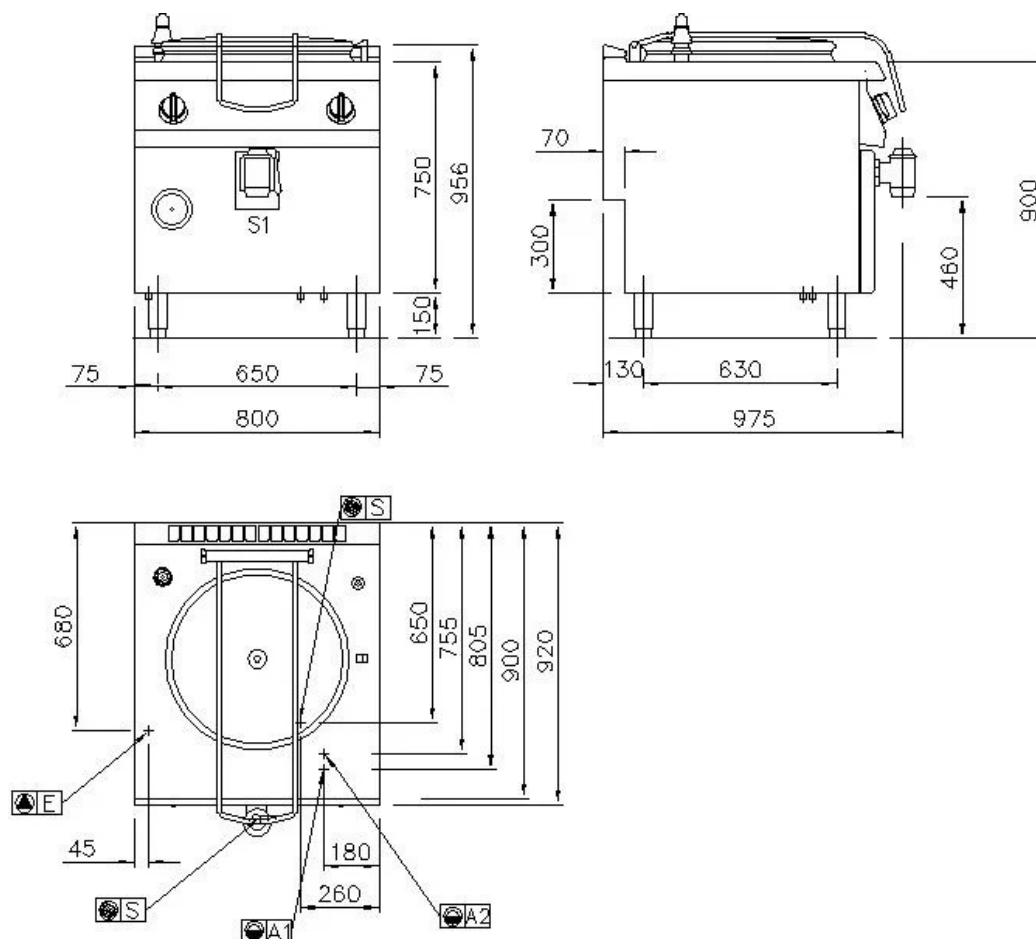

	E1	SOCKET	400 V	3N
	AF	COLD WATER	Ø 3/4"	100 mm
	AC	HOT WATER	Ø 3/4"	100 mm
	G	GAS		
	S	DRAINING	Ø 40MM	0 mm

NOTES FOR THE INSTALLER:

All water and gas connections must be fitted with a shut-off valve or ball valve.
Main gas connections must be provided of closing gate device.

Gas connections must not use welded tubes.

Gas connections must be jacketed according to current rules in the country.

Electric connections must be provided of safety switch and a minimum exit wire of 1,5 meter lenght (except where otherwise required in the drawing).

All sockets must be built according to safety-rules in force. Suited for humid room and settled with necessary plug.

All electric connections must be provided of main switch.

The specification shown in this document are to be considered not bounding.

The company reserves the right to make technical changes at any moment.