

Electric Ranges

4 Electric hotplates with electric oven

NECE74EQ

700 line

SILKO
IDEAS. WELL DONE

Free-standing electric range with electric oven constructed in Aisi 304 stainless steel. Electric hob constructed in Aisi 304 stainless steel. 15/10 thick pressed top, designed for flush alignment. Recessed top to contain spills. Squared or round sealed hotplates in cast-iron with 2,6 kW output. Hotplates equipped with automatic reset safety thermostat which trips in the event the appliance is switched on without a pan. 7-position selector switch for heat adjustment. Indicator led for verifying correct appliance operation. GN 2/1 conventional electric oven.

Oven heated by independently controlled top and bottom heating elements. Thermostat control providing temperature adjustment from 50°C to 300°C. Cooking chamber in stainless steel, dimensions 575x650x300h mm. Oven bottom plate in black enamelled iron. Oven inner door in stainless steel with labyrinth seal. 4-position selector switch, safety thermostat. Indicator leds indicating correct oven operation. Oven power: 6 kW. Appliance equipped with height adjustable feet in stainless steel.



Width mm.:	800
Depth mm.:	730
Height mm.:	900
Weight kg.:	-
Volume m³:	0,8
Voltage: El.	VAC400-3N 50/60 Hz
PowerkW.:	16,4
Gas Power (kw):	-

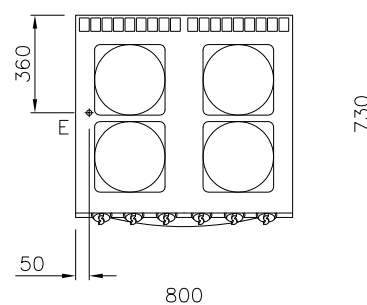
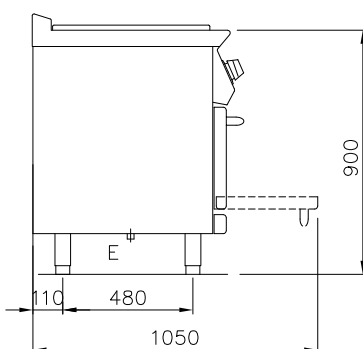
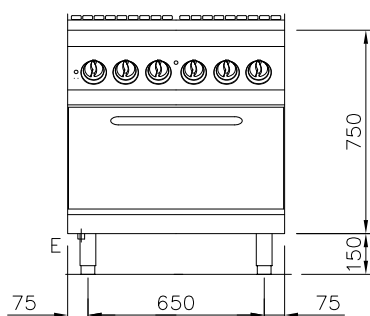

NOTE

- All dimensions reported on the drawing are meant with finished tiled-floor and side walls
- Main gas connections must be provided of closing gate device
- Mass connections must not use welded tubes
- Gas connections must be settled according to current rules in the country
- Electric connections must be provided of safety switch and a minimum exit wire of 1,5 meter length (except where otherwise required in the drawing) - All sockets must be built according to safety-rules in force. Suited for humid room and settled with necessary plug
- All electric connections must be provided of main switch

E = Electric

Silko - Ali S.p.A.
Via Cal Larga, 8
Z.I San Giacomo di Veglia
31029 Vittorio Veneto
(TV) ITALY
T (+39) 0438 911930
F (+39) 0438 506291
info@silko.it

www.silko.it